

Technical Tips – KLEI™Harmony Banana

Connecting the Harmony™Banana to cable

- The Harmony™Banana housing is a thermo polymer that has excellent resonance, electrical, and thermal properties.
- The Harmony™Banana pin is robust but if you have limited soldering experience, ask your Dealer to do the job.
- The Harmony™Banana pin is designed to accept conductor wire up to 4.0mm diameter (approx 6awg). This accounts for most cable conductors/wire sizes.
- [Technical Tips – KLEI™Harmony Banana](#)



Steps

1. Remove the plastic Harmony™Banana housing from the Harmony™Banana pin, by sliding it forward.
2. Place the Harmony™Banana pin onto a 2nd (cheap) Banana pin, where the housing of the 2nd Banana is secured and the 2nd Banana (housing & pin) becomes a holder and heat sink.
3. You can do this by using a hobby vice and putting the 2nd (cheap) banana upside down in the vice. Once held in the vice put the back of the KLE banana pin onto the 2nd banana pin which is held in the vice. The 2nd banana held in the vice also acts as a useful heat sink.
4. This will free up both hands and allow more precise soldering. Always support the cable throughout the soldering process, so the weight of the cable does not exert undue force on the soldering barrel.
5. Strip enough insulation from the conductor wire(s), to be soldered, ensuring that the wire can be inserted into the top/short barrel and reach the angled front edge/tip of the top/short barrel.
6. Tin the bare conductor wire with solder. For best results use a very high eutectic (flowing type) solder or solder with high silver content together with a flux.
7. Insert the tinned conductor wire into the top barrel, which is the shorter of the two barrels, ensuring the tinned wire tip reaches the angled front edge/tip of the top barrel.
8. Solder the tinned conductor wire in place by applying solder to the wire and barrel, at the angled front edge of the top/short barrel then allow the soldered wire/barrel to cool down. While soldering ensure, at all times, that the tinned conductor wire is pressed against the barrel.
9. You can do this by using a small blade screwdriver, to apply a small amount of pressure on the bare wire being soldered, especially as the solder is cooling.
10. Insert the Harmony™Banana pin into the plastic Harmony™Banana housing.
11. Fold the small plastic Harmony™Banana housing door into place then press and ensure the locking tags click into place.
12. Congratulations, you have reached the end and hopefully been successful in creating/building your SCs (Speaker Cables)... Well Done 😊

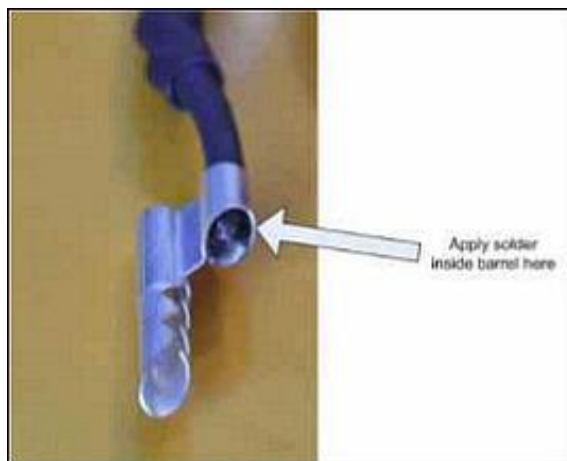

Further

- We would suggest you allow >100 hrs (preferably >200 hrs) of playing music through the SCs (Speaker Cables) to burnin/cook the Harmony™Bananas.
- We have found when comparing ICs, due to the Harmony™Bananas having extremely high resolution, that once the SCs are attached to the Binding Posts that a period of at least 90 mins (preferably 180

Technical Tips – KLEI™Harmony Banana

mins) is required for the Harmony™Banana/Post connections to settle before any serious listening comparisons are performed.

Opening the rear door/latch: once closed, that the Harmony™Banana housing rear door/latch has been designed to be strongly locked, so, to re-open the Harmony™Banana housing rear door/latch, in order to remove the plug from the speaker cable connection...

1. Position the thumb at the top of the door to prevent/stop the rear door from flying open, too quickly.
2. Insert a small bladed screw driver into the bottom top longer barrel's rear opening to engage the door, while ensuring not to engage the conductive banana pin assembly.
3. Using the small bladed screw driver as a lever, against the opening, gently lever/pry the door open. When the door/latch opens you will feel the top of the door open onto your thumb where your thumb will act to prevent the door from flying open.
4. Congratulations, you have reached the end and hopefully been successful in carefully opening the Harmony™Banana housing rear door/latch... Well Done 😊

OR

1. Insert another Banana into the plastic housing part only... I recommend that you use an old Banana and NOT another KLEI™Classic Harmony Banana.
2. Ensure the nose of the banana is NOT inserted into the metal barrel part of the banana pin, as it may damage the banana pin.
3. Gently pry the door open.
4. Congratulations, you have reached the end and hopefully been successful in carefully opening the Harmony™Banana housing rear door/latch... Well Done 😊



Keith Louis Eichmann Innovations (KLEI)

Ph. +61 (0) 406614044

Email: KLEInnovations@clubtelco.com

Skype: EichersKL

www.KLEInnovations.com